

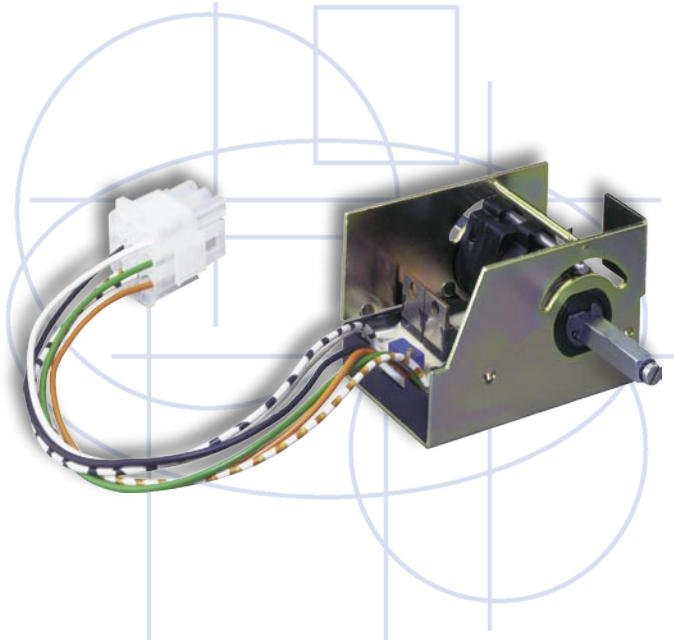

MODEL ET-126



DESCRIPTION

The Curtis throttle assembly provides an analog 0-5V output proportional to throttle position for interfacing with motor speed controllers.

APPLICATION

This electronic throttle is ideal for use in material handling, golf cars, on-road and other electric vehicle applications which require a 0-5V input for speed control.

FEATURES

- Hall effect sensors and solid state MOSFET contactor drivers minimize moving parts, thereby increasing reliability and Mean Time Between Failure.
- Symmetrical throttle response in both forward and reverse directions ensures smooth, concise acceleration and deceleration in both directions.
- Minimal deadband areas at both zero and full throttle positions eliminates hesitation when beginning to accelerate or decelerate.
- Environmental protection of major components through an epoxy layer over the circuit board assures operation in harsh environmental conditions.
- Wig-wag type throttle returns the throttle to neutral for convenience and safety.
- Input polarity protection to ensure no damage occurs to the throttle if it is incorrectly wired.
- Easy to install.

SPECIFICATIONS

Operating voltage: 13 – 58VDC

Throttle output range: 0 to 5 Volts

Maximum throttle output: 5.3 Volts

Minimum throttle output: 0 Volts

Maximum deadband at zero throttle: 10 degrees

Maximum deadband at full throttle: 10 degrees

Forward/Reverse current: 1.5 amp max

Symmetrical throttle response in both directions

CURTIS INSTRUMENTS, INC.
200 KISCO AVENUE
MT. KISCO, NY 10549 USA
TEL (914) 666-2971
FAX (914) 666-2188

CURTIS INSTRUMENTS, (UK) LTD.
5 UPPER PRIORY STREET
NORTHAMPTON NN1 2PT, ENGLAND
TEL 44 (0) 1604-629755
FAX 44 (0) 1604-629876

**CURTIS INSTRUMENTS INDIA
PRIVATE LTD.**
1199, GHOLE ROAD
PUNE 411004, INDIA
TEL 91 (0) 20-5531288
FAX 91 (0) 20-5539192

MODEL ET-126

DIMENSIONS mm

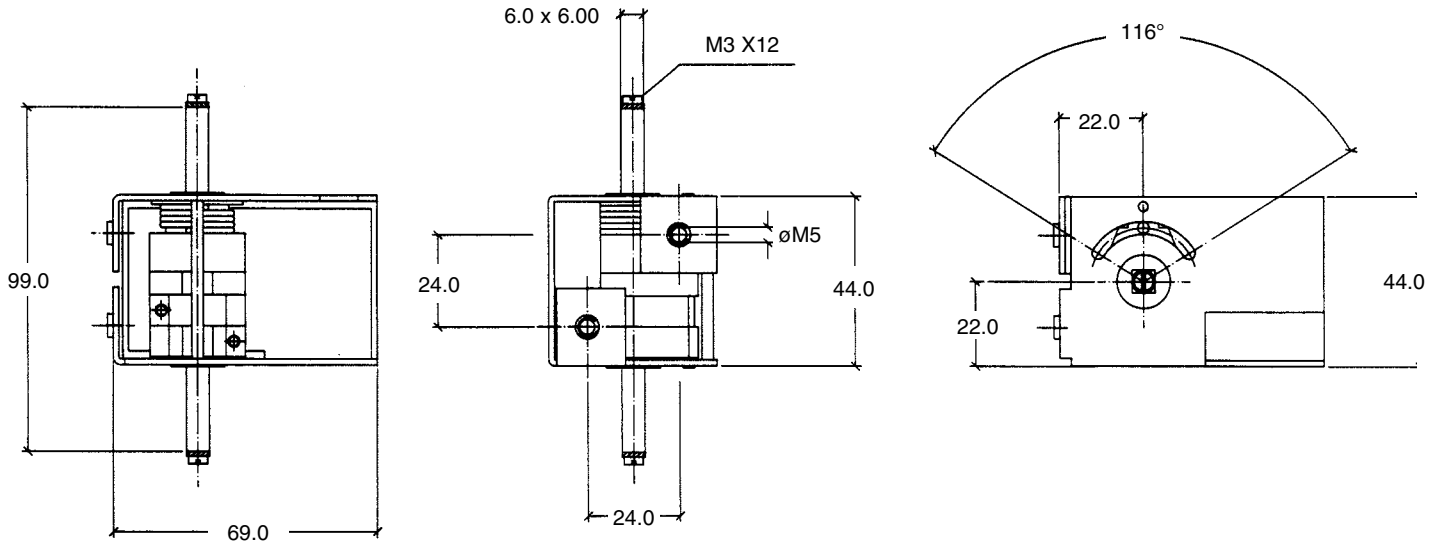

INSTALLATION

Mounting: Two M5 screws

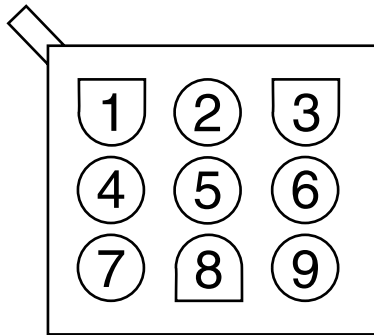

ET-126 Throttle

1	Pot Lo
2	Battery + after KSI
3	Reverse
4	Forward
5	No connect
6	No connect
7	Battery -
8	0-5V output
9	No connect

ET-126 Throttle
 AMP Mate-N-Lock Connector
 Female p/n: AMP 350720-1
 With pins: 350561-1

WARRANTY Two year limited warranty from time of delivery.